

# WP110 Waterproofing Retaining Walls on Strip Footing

## Preparation:

1. All surfaces to be waterproofed must be firm, clean, dry, sound and smooth. All grease, oil, wax, curing compounds, loose material, paint and any other contaminants must be removed, masonry surfaces must be pointed flush and surface defects repaired. New concrete must be cured for a minimum of 28 days.
2. External corners to be waterproofed must be bevelled to ensure a smooth transition of membrane from vertical to horizontal surfaces.

## Installation:

1. Repair all surface defects on retaining wall masonry surfaces with [Aftek Penapatch Structural HB80](#).

[Aftek Penapatch Structural HB80](#) is a high strength; high build shrinkage compensated structural repair mortar.

2. Install a Gunnable Waterstop around all penetrations. The waterstop must be packed in between at least a 50mm cover of [Aftek Penapatch Structural HB80](#).

Gunnable Waterstop products are caulk grade, single component swelling pastes used to stop water infiltration through concrete construction joints.

3. Porous substrates must be adequately dampened to a point of dry saturation with clean water prior to membrane application.

4. Apply [WPA 160](#) primer to non-porous surfaces, such as PVC and metal pipe penetrations.

[WPA 160](#) is a specialised solvent free primer designed for enhancing the adhesion of subsequent membranes, adhesives, toppings and decorative finishes over non-porous substrates.

5. Apply [WPA 100](#) membrane to the external side and top of the retaining wall, ensuring that the first coat has completely dried before applying the second coat.

[WPA 100](#) is a single component, fibre reinforced, rapid drying, cementitious waterproofing membrane.

6. All transitions must be detailed utilising [WPA Elastoband](#) or [WPA Butyl Tape](#).

[WPA Elastoband](#) is an innovative detailing system designed for waterproofing and sealing all types of joints, junctions and transitions subjected to movement.

[WPA Butyl Tape](#) is a multi-purpose self-adhesive detailing tape incorporating a fleece face layer with a release backing film and self-adhesive butyl rubber on the underside. It provides a waterproof seal between most types of joints and transitions in both internal and external applications

7. Install [WPA Drainage Cell](#) to all waterproofed surfaces below ground level.

[WPA Drainage Cell](#) is a two-core drainage sheet consisting of a non-woven geotextile filter layer thermally welded to a water impermeable, recycled HDPE (High Density Polyethylene) drainage membrane.

8. Install slotted drainage pipe wrapped in geotextile next to the slab edge.

9. Cover drainage pipe with a minimum of 300mm of gravel and cover gravel with additional geotextile filter layer.

10. Backfill with clean material.

11. Ensure that the membrane exposed above ground level is protected by selected surface finishes or capping material.

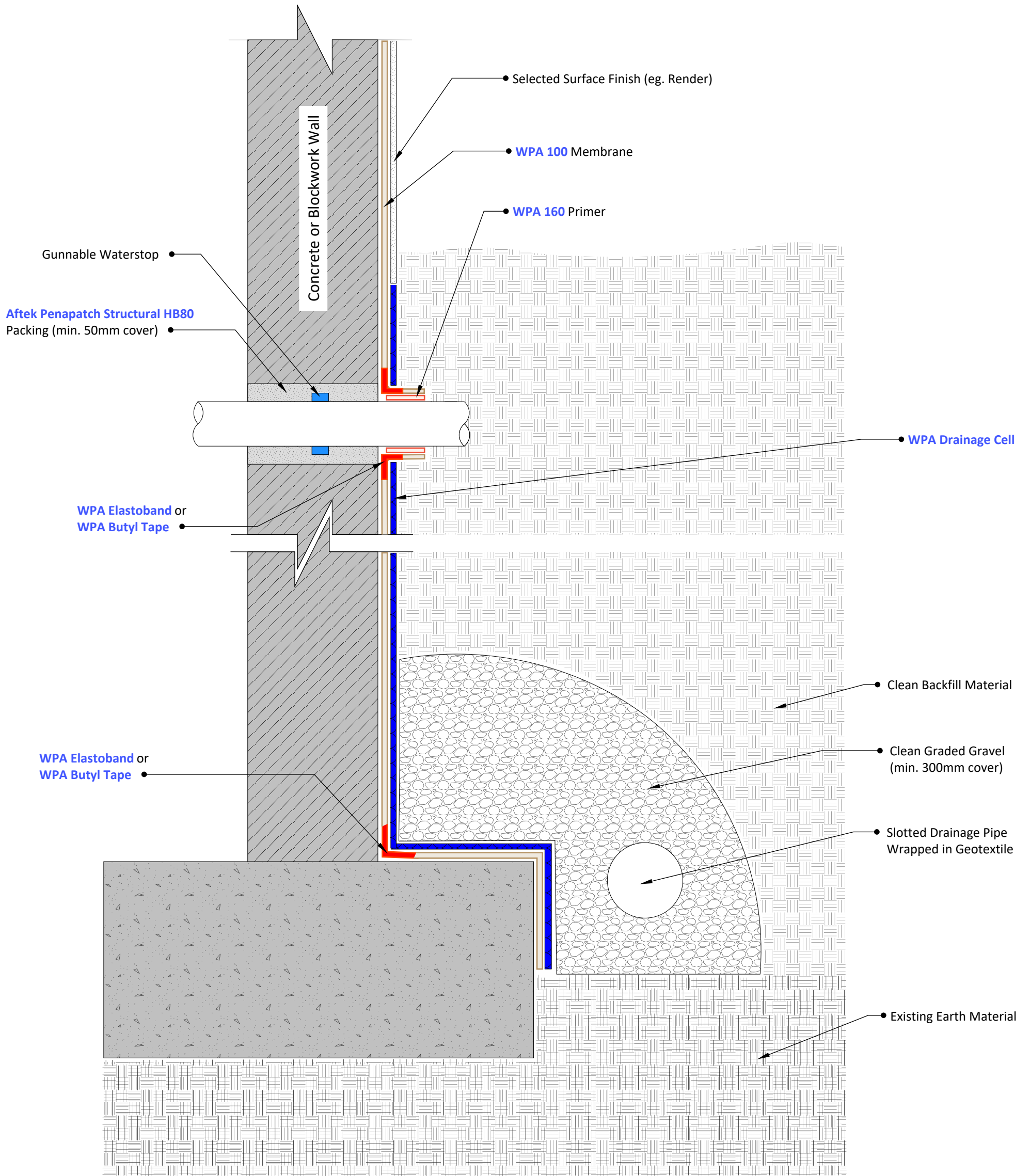

1 Cross Section  
NTS

© COPYRIGHT BAYSET PTY LTD  
ANY FORM OF REPRODUCTION OF THIS DRAWING IN FULL OR IN PART WITHOUT THE WRITTEN PERMISSION OF BAYSET PTY LTD CONSTITUTES AN INFRINGEMENT OF COPYRIGHT



**Waterproofing Retaining Walls  
on Strip Footing**

DRAWING NUMBER

**WP110**

SCALE: NTS

RELEASE: August 21, 2024

DRAWN BY: CS