

## WP340 Waterproofing Concrete Balconies - Pavers on Pedestals

### Preparation:

1. All surfaces to be waterproofed must be firm, clean, dry, sound and smooth. All grease, oil, wax, curing compounds, loose material, paint and any other contaminants must be removed, masonry surfaces must be pointed flush and surface defects repaired. New concrete must be cured for a minimum of 28 days.
2. External corners to be waterproofed must be bevelled to ensure a smooth transition of membrane from vertical to horizontal surfaces.

### Installation:

1. Waterproofing installation shall be in accordance with AS 4654.2 Waterproofing Membranes for External Above-Ground Use.
2. Install a puddle flange to all waste pipes, ensuring that puddle flanges are recessed into the substrate.
3. Install an appropriate fillet (bond breaker) to all transitions using **WPA MS** or **WPA SPUR**.

**WPA MS** is a single component, moisture cured silane modified hybrid sealant.

**WPA SPUR** is a high quality, professional, universal, low modulus sealant based on hybrid technology.

4. Prime PVC and all other non-porous substrates using **WPA 160** primer.

**WPA 160** is a specialised solvent free primer designed for enhancing the adhesion of subsequent membranes, adhesives, toppings and decorative finishes over non-porous substrates.

5. Apply **WPA 460** or **WPA 560** primer to the substrate being waterproofed.

**WPA 460** is a two-part, water-based epoxy primer, used to seal concrete and masonry surfaces.

**WPA 560** is a two-part, water-based epoxy primer, designed as a water and vapour proof coating under waterproofing membranes.

6. Apply **WPA 230UV** membrane in a minimum of two coats to achieve the required dry film thickness. Ensure that the previous coat has completely dried before applying the subsequent coat(s). NOTE: All penetrations must be waterproofed.

**WPA 230UV** is an elastomeric, fibre reinforced, water-based polyurethane membrane system designed for exposed or under tile applications.

7. Install overflashing where required.

8. Install suitable pavers or tiles using an appropriate pedestal system.

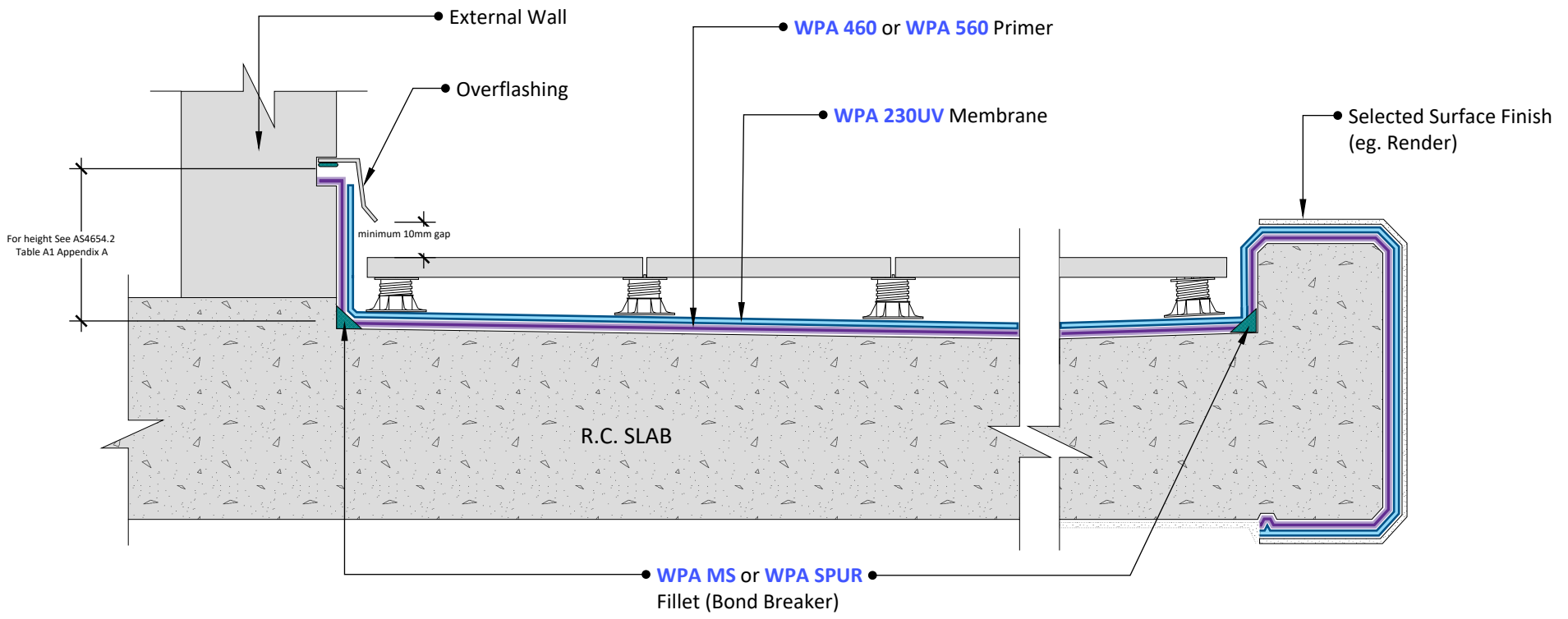

1 Floor/Wall Junction  
Scale: NTS

2 Hob  
Scale: NTS

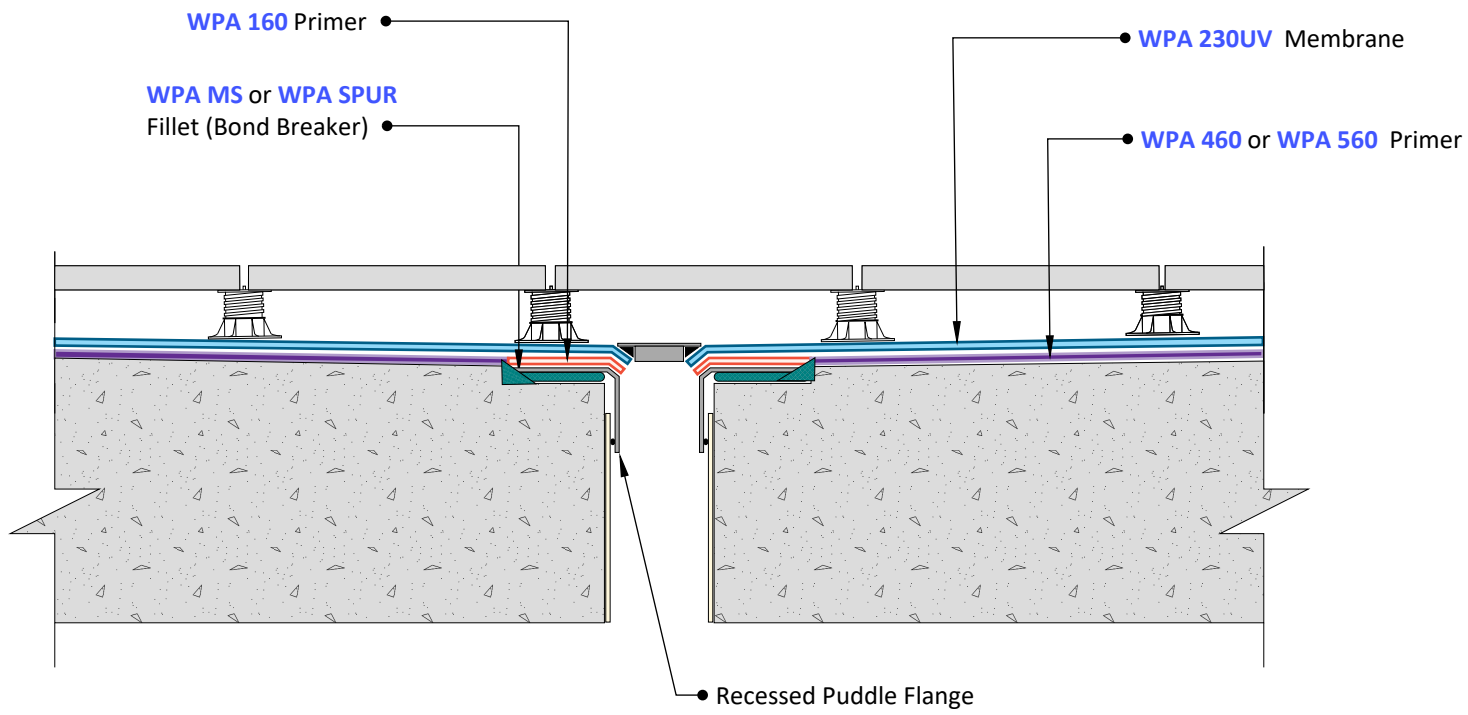

3 Waterproofing at waste  
Scale: NTS

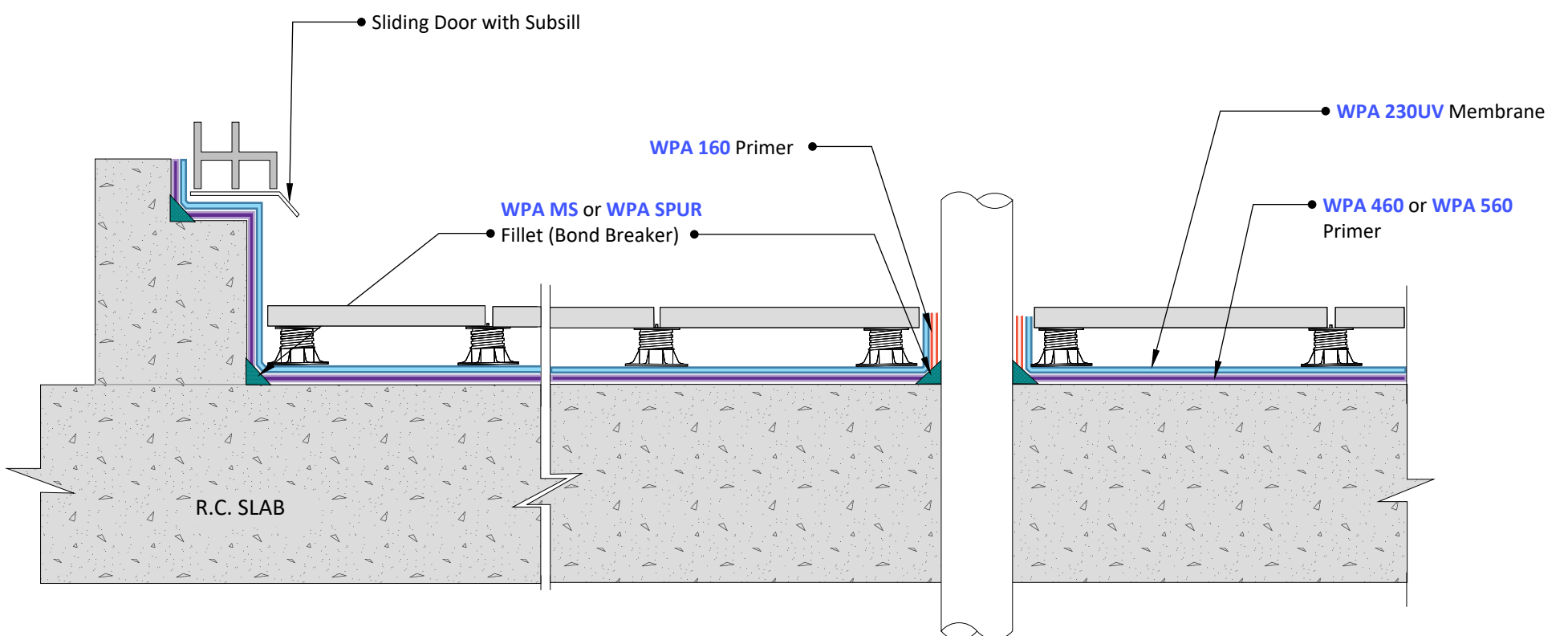

4 Sliding Door Detail  
Scale: NTS

4 Pipe Penetration  
Scale: NTS

© COPYRIGHT BAYSET PTY LTD  
ANY FORM OF REPRODUCTION OF THIS DRAWING IN FULL OR IN PART WITHOUT THE WRITTEN PERMISSION OF BAYSET PTY LTD CONSTITUTES AN INFRINGEMENT OF COPYRIGHT



**Waterproofing Concrete Balconies  
- Pavers on Pedestals**

DRAWING NUMBER

**WP340**

SCALE: NTS

RELEASE: November 6, 2023

DRAWN BY: CS